

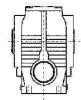

**DS系列**

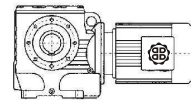
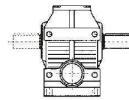
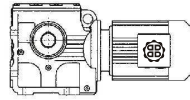
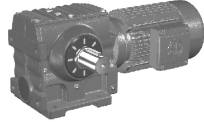
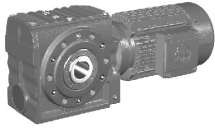

DS系列减速机有以下设计方案:  
DS series gear units are available in the following designs:

DS...Y...  
底部轴伸式安装斜齿-蜗轮蜗杆减速机  
Foot-mounted helical-worm gear units with solid shaft

DSA...Y...  
空心轴安装斜齿-蜗轮蜗杆减速机  
Helical-worm gear units with hollow shaft

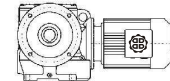
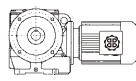
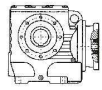
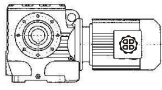

DSAZ...Y...  
小法兰空心轴安装斜齿-蜗轮蜗杆减速机  
Short-flange mounted helical-worm gear units with hollow shaft

DSA(DS、DSF、DSAF、DSAZ)...F...Y...  
电机用户自配或配特殊电机时需加联接法兰  
When equipping the user's motor or the special one, the flange is required to be connected

DSF...Y...  
法兰轴伸式安装斜齿-蜗轮蜗杆减速机  
Flange-mounted helical-worm gear units with solid shaft

DSAF...Y...  
法兰空心轴安装斜齿-蜗轮蜗杆减速机  
Flange-mounted helical-worm gear units with hollow shaft

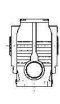
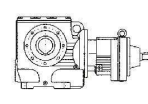
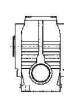
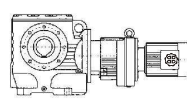
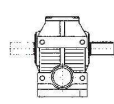
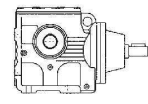
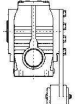
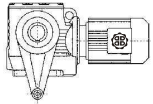

DSAT...Y...  
带防转臂空心轴安装斜齿-蜗轮蜗杆减速机  
Torque-arm-mounted helical-worm gear units with hollow shaft

DS(DSF、DSA、DSAF、DSAZ)S...  
轴输入的斜齿-蜗轮蜗杆减速机  
Shaft input helical-worm gear units

DSA(DS、DSF、DSAF、DSAZ)...DR...Y...  
组合式斜齿-蜗轮蜗杆减速机  
Combinatorial helical-worm gear units

DSA(DS、DSF、DSAF、DSAZ)S...DR...  
轴输入的组合式斜齿-蜗轮蜗杆减速机  
Shaft input combinatorial helical-worm gear units

**DS**

**DS系列斜齿蜗轮-蜗轮蜗杆减速机**  
**DS SERIES OBLIQUE-WORM AND GEAR-WORM DECELERATOR**

**型号表示法 Representation for type**

**双极型号示例**

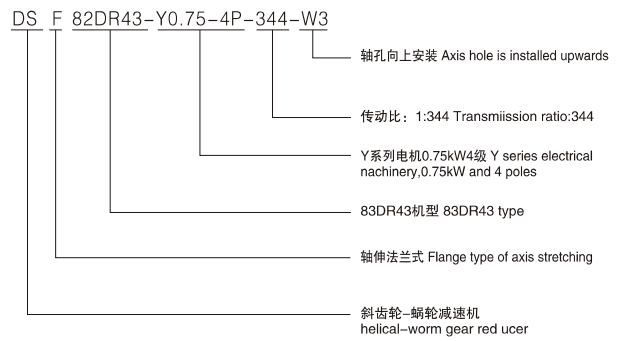
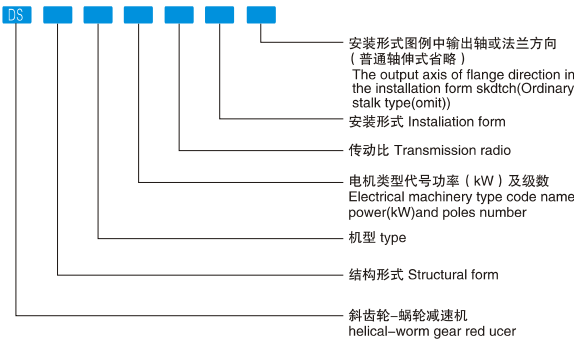

电机代号 Motor code:

电机类型 Motor type	普通 (更新) Ordinary (renew)	防爆 Explosion-proof	直流 Direct current	电磁制动 Electromagnetic	变频调速 Frequency control	电磁变频调速 Electromagnetic Frequency control	多速 Multi-speed
类型代号 type code	Y(Y2)	YB	Z	YEJ2	YVF2	YEVF2	YD2/YEJ2

**结构形式 Structure forms**

普通轴伸式联接表示 (省略) (Coupling denotation for ordinary axis stretching (omit))	轴装式联接表示: A Coupling denotation for axis - installation type: A	轴伸法兰式联接表示: F Coupling denotation for axis stretching flange type: F
普通轴伸式双轴型联接表示: S Coupling denotation for ordinary axis stretching flange type: S	轴装式双轴型联接表示: AS Coupling denotation for axis - installation double-shaft type: AS	轴装法兰式联接表示: AF Coupling denotation for axis stretching flange type: AF
轴伸法兰式双轴型联接表示: FS Coupling denotation for axis - installation double-shaft type: FS	轴装法兰式双轴型联接表示: AFS Coupling denotation for axis - installation flange type: AFS	扭力臂联接表示: T Express of the tensional arm joint: T



### DS系列重量表 DS Series weight table

Type	DS32	DS42	DS52	DS62	DS72	DS82	DS92	DS102	DS122
m(kg)	7	10	14	26	50	100	170	237	390

注：带输入轴、输入法兰另加10%；带电机根据所配规格另加。

Notes: Weight of reducer with input shaft and input flange should be added 10%; if there is a motor, please add weight additionally according to motor type.

### DS系列Fr(N)表 DS Series Fr(N)table

n <sub>1</sub> (r/min)	n <sub>2</sub> (r/min)	i N	Fr(N)								
			DS32	DS42	DS52	DS62	DS72	DS82	DS92	DS102	DS122
1450	61	23.8	2151	3035	5041	5007	5075	18530	21165	30345	42500
	50	29.1	2380	3332	5542	5304	6265	20995	24650	35275	47600
	44	32.6	2380	3502	5814	5559	6571	22100	25840	36975	49725
	39	36.8	2550	3502	5950	6163	6919	23035	26605	38063	51255
	35	41.1	2550	3766	6222	6163	7438	23970	27880	39950	53720
	31	46.5	2550	4004	6392	6851	7659	24650	28985	41565	56100
	28.3	51.3	2550	4123	6392	6851	8203	24650	29325	43095	60350
	25.2	57.5	2550	4522	6392	7370	9860	24650	29325	43095	60350
	21.4	67.8	2550	4556	6392	7378	10455	24650	29325	43095	60350

备注：各规格更低的输出转速按以上最大的Fr值。 Notes: If there is lower output speed, please choose the maximum Fr in above table.

### DS 系列选型举例 DS Series selection example

#### 减速机 Geared motors

例：输入功率1.5kW，(四级1450rpm)一般冲击，每天运行8小时，环境温度40℃减速比139，(即公称输出转速为10.4r/min)，

即确定 $fs=1.25$ ,  $ft=1.35$ ,  $P_{m1} \geq P_m \times fs \times ft = 1.5 \times 1.5 \times 1.35 = 2.53$ (kW)

即选取DS82。

选法兰水平式安装，配实心轴输出，安装形式FW。

则型号规格为DSF82-Y1.5-139-FW。

Example: Input power of 1.5kW, (4 electrodes 1450rpm) mode rate shock load, operate for 8 hours per day, ambient temperature is 40°C, ratio of 139 (that is nominal output speed is 10.4rpm),

namely  $fs=1.35$ ,  $P_{m1} \geq P_m \times fs \times ft = 1.5 \times 1.5 \times 1.35 = 2.53$ (kW)

So select DS82 according to transmission capacity table, flange level output, solid output shaft FW mounting position. type is expressed: DSF82-Y1.5-139-FW

$$\text{输出扭矩 (N.m)} = \frac{\text{输入功率} \times 9550}{\text{输出转速}} \times \text{效率} = \frac{1.5 \times 9550}{11.3} \times 60\% = 760.6(\text{N.m})$$

$$M_2 = \frac{P_m \times 9550}{n_2} \times \eta = \frac{1.5 \times 9550}{11.3} \times 60\% = 760.6(\text{N.m})$$

#### 双轴型 Geared motors:

例：需使用系数为1.25，输入转速为200r/min，输入功率0.37kW，输出转速5r/min，即可得出减速比40，选公称减速比iN=41.1，均匀负载无冲击，每天运行12小时，环境温度40℃，确认 $fs=1.25$ ,  $ft=1.5$ 。

$$MN_2 \geq M_2 \cdot fs \cdot ft = \frac{P_1 \cdot 9550}{n_1} \cdot i \cdot \eta \cdot fs \cdot ft = \frac{0.37 \times 9550}{200} \times 41.1 \times 0.77 \times 1.25 \times 1.5 = 1048(\text{N} \cdot \text{m})$$

可选DS82。

Example: (1) Require useful factor of 1.25, input speed of 200r/min, input power of 0.37kW, output speed of 5rpm, may calculate out ratio of 40, select nominal ratio iN=41.1. Uniform load, no shock, run for 12 hours per day, ambient temperature is 40°C, so that,  $fs=1.00$ ,  $ft=1.50$ . We can calculate torque of the reducer loading, namely.

$$MN_2 \geq M_2 \cdot ft = \frac{P_1 \cdot 9550}{n_1} \cdot i \cdot \eta \cdot fs \cdot ft = \frac{0.37 \times 9550}{200} \times 41.1 \times 0.77 \times 1.25 \times 1.5 = 1048(\text{N} \cdot \text{m})$$

例：需输出扭矩100N·m，输入转速500r/min，减速比175，均匀负载，每天运行2小时，环境温度20℃，即确认 $fs=1.00$ ,  $ft=1.00$ 。

$$MN_2 \geq M_2 \times fs \times ft = 100 \times 1.00 \times 1.00 = 100(\text{N.m})$$

根据传动能力表选DS42。

So select DS82 according to transmission capacity table. (2) Required output torque of 100Nm, output speed of 500rpm, ratio of 175, uniform load, run for 2 hours per day, ambient temperature is 20°C, so that,  $fs=1.00$ ,  $ft=1.00$ .

$$MN_2 \geq M_2 \times fs \times ft = 100 \times 1.00 \times 1.00 = 100(\text{N.m})$$

So select DS42 according to transmission capacity table.



**DSA型 DSA type DSAF型 DSAF type**

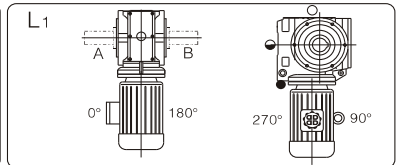
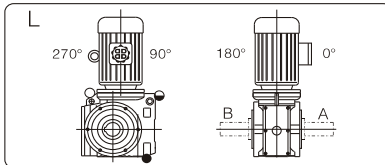
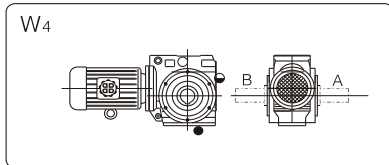
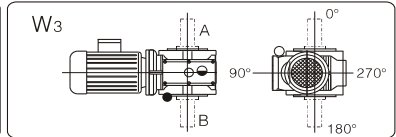
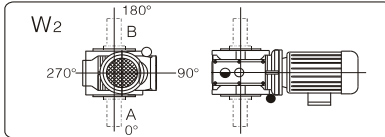
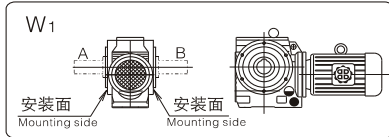

**DSF型 (DSF type)**

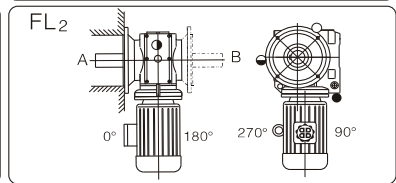
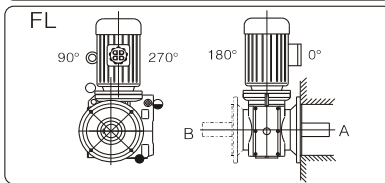
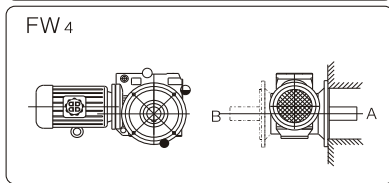
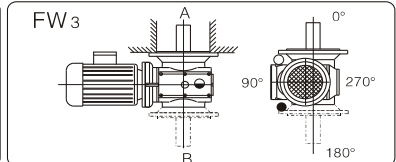
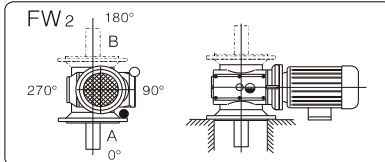
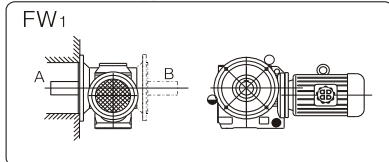

**DS型 (DS type)**

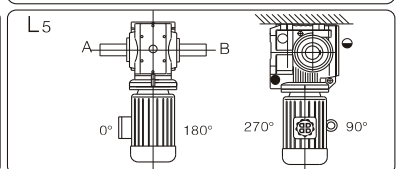
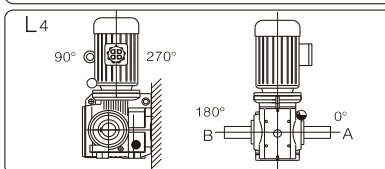
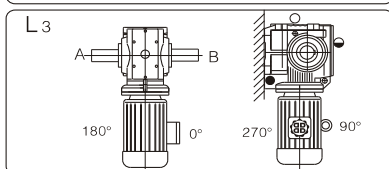
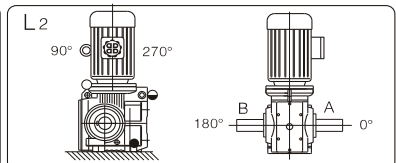
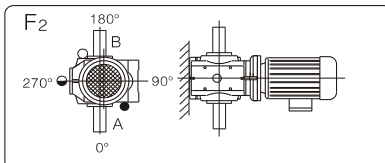
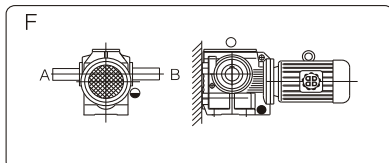
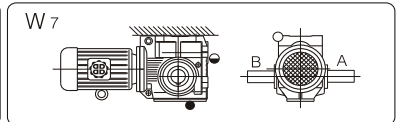
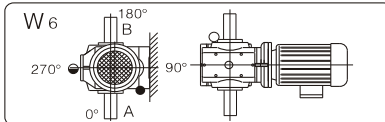
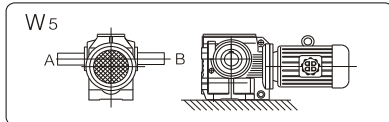

**DSA/T型 (DSA/T type)**

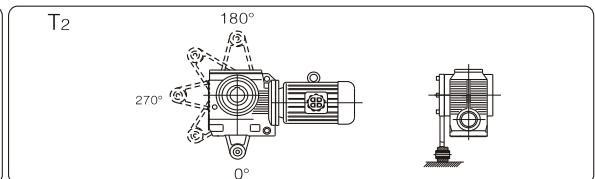
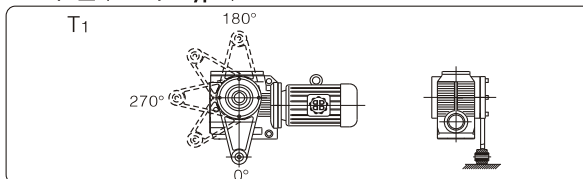

注：●—表示放油孔 ○—表示油镜 ○—表示加油通气孔  
Notes: ●— It denotes exhaust outlet ○— It denotes oil mirror ○— It denotes filler air vent

DS



DS系列传动功能表 DS SERIES TRANSMISSION CAPACITY TABLE

n 1 (r/min)	n 2 (r/min)	iN	DS32			DS42			DS52			DS62			DS72			
			最大允许直联电机0.55kw Maximum power of directly connected motor 0.55kw			最大允许直联电机1.1kw Maximum power of directly connected motor 1.1kw			最大允许直联电机1.5kw Maximum power of directly connected motor 1.5kw			最大允许直联电机2.2kw Maximum power of directly connected motor 2.2kw			最大允许直联电机5.5kw Maximum power of directly connected motor 5.5kw			
			MN2 (N.m)	ieX	PN1 (Kw)	MN2 (N.m)	ieX	PN1 (Kw)	MN2 (N.m)	ieX	PN1 (Kw)	MN2 (N.m)	ieX	PN1 (Kw)	MN2 (N.m)	ieX	PN1 (Kw)	
1450	61	23.8	62	23.90	0.51	125	23.90	1.03	205	23.90	1.69	395	24.11	3.22	815	24.11	6.65	
	50	29.1	63	29.46	0.42	130	29.46	0.87	205	29.46	1.37	395	28.80	2.70	840	28.80	5.74	
	44	32.6	64	32.88	0.38	130	32.88	0.78	205	32.88	1.23	395	32.68	2.38	870	32.68	5.24	
	39	36.9	65	36.88	0.35	130	36.88	0.69	205	36.88	1.09	395	36.35	2.14	905	36.35	4.90	
	35	41.1	67	41.59	0.32	130	41.59	0.61	205	41.59	0.97	395	40.63	1.91	915	40.63	4.43	
	31	46.5	67	47.25	0.28	130	47.25	0.54	205	47.25	0.85	395	45.68	1.70	915	45.68	3.94	
	28.3	51.3	69	50.53	0.27	130	50.53	0.50	205	50.53	0.80	395	51.75	1.50	915	51.75	3.48	
	25.2	57.5	69	58.24	0.23	130	58.24	0.44	205	58.24	0.69	395	56.74	1.37	915	56.74	3.17	
	21.4	67.8	69	68.00	0.20	130	68.00	0.38	205	68.00	0.59	395	67.50	1.15	915	67.50	2.67	
	19.7	73.7	69	71.22	0.24	140	71.22	0.48	235	71.22	0.81	435	72.32	1.47	860	72.32	2.91	
	16.6	87.3	71	88.39	0.20	140	88.39	0.39	245	88.39	0.68	435	86.40	1.23	885	86.40	2.50	
	14.7	98.5	72	98.65	0.18	140	98.65	0.35	245	98.65	0.61	435	98.04	1.08	915	98.04	2.28	
	13.2	110	73	110.6	0.16	140	110.6	0.31	245	110.6	0.54	435	109.0	0.98	940	109.0	2.11	
	11.8	123	74	124.8	0.15	140	124.8	0.27	245	124.8	0.48	435	121.9	0.87	970	121.9	1.94	
	10.4	139	75	141.8	0.13	140	141.8	0.24	245	141.8	0.42	435	137.1	0.78	1000	137.1	1.78	
	9.4	154	77	151.6	0.12	140	151.6	0.23	245	151.6	0.40	435	155.3	0.69	1000	155.3	1.57	
	8.3	175	79	174.7	0.11	140	174.7	0.20	245	174.7	0.34	435	170.2	0.62	1025	170.2	1.47	
	7.1	203	79	204.0	0.90	140	204.0	0.17	245	204.0	0.29	435	202.5	0.53	1055	202.5	1.27	
	6.3	229										435	230.0	0.46	1055	235.7	1.09	
	5.8	252										435	246.2	0.43	1055	249.8	1.03	
5.1	283										435	285.0	0.37	1055	282.5	0.91		
4.6	324																	
4.2	346																	
3.7	389																	
960	6.9	139				140	141.8	0.16	245	141.8	0.28							
	6.2	154				140	151.6	0.15	245	151.6	0.26							
	5.5	175				140	174.7	0.13	245	174.7	0.22							
	4.7	203							245	204.0	0.19	435	202.5	0.35				
	4.2	229										435	230.0	0.30	1055	235.7	0.72	
	3.8	252										435	246.2	0.28	1055	249.8	0.68	
	3.4	283										435	285.0	0.24	1055	282.5	0.60	
	3.0	324																
	2.8	346																
	2.5	389																
710	2.5	283													1055	282.5	0.44	
	2.2	324																
	2.1	346																
	1.8	389																

DS



DS系列传动功能表 DS SERIES TRANSMISSION CAPACITY TABLE

n <sub>1</sub> (r/min)	n <sub>2</sub> (r/min)	iN	DS82			DS92			DS102			DS122		
			最大允许直联电机11kw Maximum power of directly connected motor 11kw			最大允许直联电机18.5kw Maximum power of directly connected motor 18.5kw			最大允许直联电机22kw Maximum power of directly connected motor 22kw			最大允许直联电机37kw Maximum power of directly connected motor 37kw		
			MN <sub>2</sub> (N.m)	i <sub>ex</sub>	PN <sub>1</sub> (Kw)	MN <sub>2</sub> (N.m)	i <sub>ex</sub>	PN <sub>1</sub> (Kw)	MN <sub>2</sub> (N.m)	i <sub>ex</sub>	PN <sub>1</sub> (Kw)	MN <sub>2</sub> (N.m)	i <sub>ex</sub>	PN <sub>1</sub> (Kw)
1450	61	23.8	1295	23.44	10.9	2390	24.23	19.4	4085	23.44	34.4	7350	24.11	*48.5
	50	29.1	1295	28.93	8.81	2500	28.93	17.0	4280	28.93	29.2	7700	28.80	52.7
	44	32.6	1295	32.30	7.89	2660	32.31	16.2	4550	32.31	27.8	8200	32.61	49.6
	39	36.9	1295	37.22	6.85	2750	37.22	14.5	4700	37.22	24.9	8600	37.50	45.2
	35	41.1	1295	41.40	6.16	2750	41.40	13.1	4700	41.40	22.4	8600	41.54	40.8
	31	46.5	1295	46.30	5.50	2750	46.30	11.7	4700	46.30	20.0	8100	46.25	25.8
	28.3	51.3	1295	52.14	4.89	2750	52.14	10.4	4700	52.14	17.8	8600	51.82	36.7
	25.2	57.5	1295	56.74	4.49	2750	56.74	9.54	4700	56.74	16.3	8600	56.74	32.7
	21.4	67.8	1295	67.50	3.78	2750	67.50	8.02	4700	67.50	13.7	8600	67.50	29.9
	19.7	73.7	1385	70.31	4.81	2420	72.69	8.14	4520	77.14	14.3	8600	76.80	25.1
	16.6	87.3	1505	86.79	4.24	2570	86.79	7.24	4700	86.15	13.3	8420	86.96	23.7
	14.7	98.5	1565	96.92	3.95	2700	96.92	6.81	4900	99.26	12.1	8770	100.0	21.5
	13.2	110	1630	111.7	3.57	2870	111.7	6.28	5000	110.4	11.1	9000	110.8	19.9
	11.8	123	1665	124.2	3.28	2920	124.2	5.75	5150	123.5	10.2	9200	123.3	18.3
	10.4	139	1710	138.9	3.01	3050	138.9	5.37	5255	139.1	9.26	9500	138.2	16.8
	9.4	154	1750	156.4	2.73	3110	156.4	4.86	5360	151.3	8.68	9600	151.3	15.5
	8.3	175	1785	170.2	2.56	3200	170.2	4.59	5520	180.0	7.51	9900	180.0	13.5
	7.1	203	1840	202.5	2.22	3260	202.5	3.93	5645	203.0	6.81	10120	203.0	12.2
	6.3	229	1880	228.3	2.01	3330	228.3	3.56	5700	222.4	6.28	10200	222.4	11.2
	5.8	252	1895	250.2	1.85	3330	250.2	3.25	5700	258.2	5.41	10200	258.2	9.67
5.1	283	1895	275.9	1.68	3330	290.5	2.80	5700	290.5	3.04	10200	290.5	5.45	
4.6	324	1895	324.0	*1.32										
4.2	346													
3.7	389													
960	6.9	139												
	6.2	154												
	5.5	175												
	4.7	203						5645	203.0	4.49	10120	203.0	8.05	
	4.2	229						5700	222.4	4.14	10200	222.4	7.39	
	3.8	252						5700	258.1	3.57	10200	258.2	6.38	
	3.4	283	1895	275.9	1.10	3330	290.5	1.85	5700	290.5	2.02	10200	290.5	3.63
	3.0	324	1895	324.0	*0.87									
	2.8	346												
	2.5	389												
710	2.5	283												
	2.2	324	1895	324.0	*0.64									
	2.1	346												
1.8	389													

DS



**DS/DR系列传动功能表 DS/DR SERIES TRANSMISSION CAPACITY TABLE**

n 1 (r/min)	n 2 (r/min)	iN	DS32/DR33			DS42/DR33			DS52/DR33			DS62/DR33			DS72/DR33		
			最大允许直联电机0.09kw Maximum power of directly connected motor 0.09kw			最大允许直联电机0.12kw Maximum power of directly connected motor 0.12kw			最大允许直联电机0.25kw Maximum power of directly connected motor 0.25kw			最大允许直联电机0.55kw Maximum power of directly connected motor 0.55kw			最大允许直联电机0.75kw Maximum power of directly connected motor 0.75kw		
			MN2 (N.m)	ieX	PN1 (Kw)	MN2 (N.m)	ieX	PN1 (Kw)	MN2 (N.m)	ieX	PN1 (Kw)	MN2 (N.m)	ieX	PN1 (Kw)	MN2 (N.m)	ieX	PN1 (Kw)
1450	6.53	222	79	226.2	0.08	140	226.2	0.14	245	226.2	0.24	435	224.8	0.43	1055	224.8	1.05
	5.78	251	79	253.5	0.07	140	253.5	0.12	245	253.5	0.22	435	252.0	0.39	1055	252.0	0.94
	5.11	284	79	288.4	0.06	140	288.4	0.11	245	288.4	0.19	435	286.6	0.34	1055	286.6	0.83
	4.15	349	79	355.1	0.05	140	355.1	0.09	245	355.1	0.16	435	352.9	0.28	1055	352.9	0.67
	3.68	394	79	396.5	0.04	140	396.5	0.08	245	396.5	0.14	435	394.1	0.25	1055	394.1	0.60
	3.27	443	79	444.5	0.04	140	444.5	0.07	245	444.5	0.12	435	441.8	0.22	1055	441.8	0.54
	2.95	492	79	501.4	0.04	140	501.4	0.06	245	501.4	0.11	435	498.4	0.20	1055	498.4	0.48
	2.41	601	79	607.7	0.04	140	607.7	0.06	245	607.7	0.11	435	603.9	0.20	1055	603.9	0.47
	2.16	670	79	678.7	0.03	140	678.7	0.06	245	678.7	0.10	435	674.5	0.18	1055	674.5	0.43
	1.91	758	79	760.6	0.03	140	760.6	0.05	245	760.6	0.09	435	755.9	0.16	1055	755.9	0.38
	1.69	857	79	865.2	0.02	140	865.2	0.04	245	865.2	0.08	435	859.8	0.14	1055	859.8	0.33
	1.38	1054	79	1065	0.02	140	1065	0.04	245	1065	0.06	435	1059	0.11	1055	1059	0.27
	1.22	1192	79	1190	0.02	140	1190	0.03	245	1190	0.06	435	1182	0.10	1055	1182	0.24
	1.08	1340	79	1334	0.02	140	1334	0.03	245	1334	0.05	435	1326	0.09	1055	1326	0.22
	0.98	1487	79	1504	0.01	140	1504	0.03	245	1504	0.04	435	1495	0.08	1055	1495	0.19
	0.87	1675	79	1710	0.01	140	1710	0.02	245	1710	0.04	435	1699	0.07	1055	1699	0.17
	0.78	1862	79	1828	0.01	140	1828	0.02	245	1828	0.04	435	1817	0.07	1055	1817	0.16
	0.71	2049	79	2106	0.01	140	2106	0.02	245	2106	0.03	435	2093	0.06	1055	2093	0.14
	0.59	2443	79	2459	0.01	140	2459	0.01	245	2459	0.03	435	2444	0.05	1055	2444	0.12
	0.54	2679	79	2680	0.01	140	2680	0.01	245	2680	0.02	435	2664	0.04	1055	2664	0.11
	0.44	3260	79	3304	0.01	140	3304	0.01	245	3304	0.02	435	3283	0.04	1055	3283	0.09
	0.40	3664	79	3688	0.01	140	3688	0.01	245	3688	0.02	435	3665	0.03	1055	3665	0.08
	0.35	4157	79	4134	0.01	140	4134	0.01	245	4134	0.02	435	4109	0.03	1055	4109	0.07
	0.31	4689	79	4702		140	4702	0.01	245	4702	0.01	435	4673	0.03	1055	4673	0.06
	0.25	5880	79	5795		140	5795	0.01	245	5795	0.01	435	5759	0.02	1055	5759	0.05
	0.22	6560	79	6467		140	6467	0.01	245	6467	0.01	435	6428	0.02	1055	6428	0.04
	0.20	7358	79	7253		140	7253	0.01	245	7253	0.01	435	7208	0.02	1055	7208	0.04
	0.17	8323	79	8180		140	8180		245	8180	0.01	435	8129	0.01	1055	8129	0.04
	0.16	9298	79	9293		140	9293		245	9293	0.01	435	9235	0.01	1055	9235	0.03
	0.14	10244	79	9938		140	9938		245	9938	0.01	435	9877	0.01	1055	9877	0.03
0.12	11746	79	11758		140	11758		245	11758	0.01	435	11368	0.01	1055	11368	0.03	
0.11	13122	79	13358		140	13358		245	13358		435	12915	0.01	1055	12915	0.02	
0.10	14456	79	14285		140	14285		245	14285		435	13811	0.01	1055	13811	0.02	
0.09	15985	79	16464		140	16464		245	16464		435	15919	0.01	1055	15919	0.02	
0.08	19043	79	19228		140	19228		245	19228		435	18591	0.01	1055	18591	0.02	
0.07	21823																
0.06	23630																
0.05	26688																

DS



**DS/DR系列传动功能表 DS/DR SERIES TRANSMISSION CAPACITY TABLE**

n 1 (r/min)	n 2 (r/min)	iN	DS82/DR43			DS92/DR63			DS102/DR73			DS122/DR83		
			最大允许直联电机1.5kw Maximum power of directly connected motor 1.5kw			最大允许直联电机3kw Maximum power of directly connected motor 3kw			最大允许直联电机5.5kw Maximum power of directly connected motor 5.5kw			最大允许直联电机7.5kw Maximum power of directly connected motor 7.5kw		
			MN2 (N.m)	ieX	PN1 (Kw)	MN2 (N.m)	ieX	PN1 (Kw)	MN2 (N.m)	ieX	PN1 (Kw)	MN2 (N.m)	ieX	PN1 (Kw)
1450	6.53	222	1895	221.9	1.92	3330	223.6	3.35	5700	218.7	5.86	10200	220.4	10.40
	5.78	351	1895	244.2	1.74	3330	248.5	3.01	5700	243.0	5.27	10200	253.7	9.03
	5.11	284	1895	282.6	1.51	3330	284.0	2.63	5700	271.7	4.71	10200	282.4	8.12
	4.15	349	1895	336.9	1.26	3330	339.3	2.21	5700	341.2	3.75	10200	346.3	6.62
	3.68	394	1895	386.6	1.10	3330	384.8	1.94	5700	387.4	3.31	10200	385.8	5.94
	3.27	443	1895	425.7	1.00	3330	428.1	1.75	5700	430.0	2.98	10200	444.8	5.15
	2.95	492	1895	495.5	0.86	3330	478.5	1.56	5700	481.7	2.66	10200	495.0	4.63
	<b>DS122/DR73</b>													
	2.41	301	1895	579.6	0.89	3330	591.2	1.53	5700	591.6	2.62	10200	596.0	4.65
	2.16	670	1895	665.8	0.77	3330	670.7	1.35	5700	672.0	2.30	10200	677.0	4.09
	1.91	758	1895	732.7	0.70	3330	745.3	1.21	5700	746.4	2.08	10200	752.0	3.69
	1.69	857	1895	848.1	0.61	3330	851.9	1.06	5700	834.8	1.86	10200	841.0	3.30
	1.38	1054	1895	1011	0.51	3330	1018	0.89	5700	1048	1.48	10200	1056	2.62
	1.22	1192	1895	1160	0.44	3330	1154	0.78	5700	1190	1.30	10200	1199	2.31
	1.08	1340	1895	1277	0.40	3330	1284	0.70	5700	1321	1.17	10200	1331	2.08
	0.98	1487	1895	1487	0.35	3330	1435	0.63	5700	1480	1.05	10200	1491	1.86
	0.87	1675	1895	1655	0.31	3330	1614	0.56	5700	1666	0.93	10200	1678	1.65
	0.78	1862	1895	1854	0.28	3330	1828	0.50	5700	1884	0.82	10200	1898	1.46
	0.71	2049	1895	1968	0.26	3330	2004	0.45	5700	2064	0.75	10200	2079	1.33
	0.59	2443	1895	2386	0.22	3330	2384	0.38	5700	2457	0.63	10200	2475	1.12
	0.54	2679	1895	2684	0.19	3330	2649	0.34	5700	2740	0.57	10200	2760	1.00
	0.44	3260	1895	3199	0.16	3330	3159	0.29	5700	3287	0.47	10200	3312	0.84
	0.40	3664	1895	3674	0.14	3330	3626	0.25	5700	3733	0.41	10200	3761	0.74
	0.35	4157	1895	4044	0.13	3330	3992	0.23	5700	4144	0.37	10200	4175	0.66
	0.31	4689	1895	4707	0.11	3330	4646	0.19	5700	4640	0.33	10200	4675	0.59
	0.25	5880	1895	5881	0.09	3330	5796	0.16	5700	5907	0.26	10200	5951	0.47
	0.22	6560	1895	6552	0.08	3330	6467	0.14	5700	6581	0.24	10200	6630	0.42
	0.20	7358	1895	7213	0.07	3330	7119	0.13	5700	7306	0.21	10200	7360	0.38
	0.17	8323	1895	8394	0.06	3330	8286	0.11	5700	8181	0.19	10200	8242	0.34
	0.16	9298	1895	9346	0.06	3330	9225	0.10	5700	9177	0.17	10200	9245	0.30
	0.14	10244	1895	10467	0.05	3330	10332	0.09	5700	10412	0.15	10200	10490	0.26
	0.12	11746	1895	12030	0.04	3330	11875	0.08	5700	11465	0.14	10200	11390	0.24
0.11	13122	1895	13394	0.04	3330	13221	0.07	5700	12860	0.12	10200	12777	0.22	
0.10	14456	1895	15001	0.03	3330	14807	0.06	5700	14592	0.11	10200	14497	0.19	
0.09	15985	1895	15932	0.03	3330	15722	0.06	5700	15997	0.10	10200	15893	0.17	
0.08	19043	1895	19307	0.03	3330	19057	0.05	5700	19043	0.08	10200	18920	0.15	
0.07	21823	1895	22266	0.02	3330	21960	0.04	5700	21616	0.07	10200	21476	0.13	
0.06	23630	1895	24044	0.02	3330	23724	0.04	5700	23146	0.07	10200	22996	0.12	
0.05	26688								26777	0.06	10200	26604	0.10	

**DS**



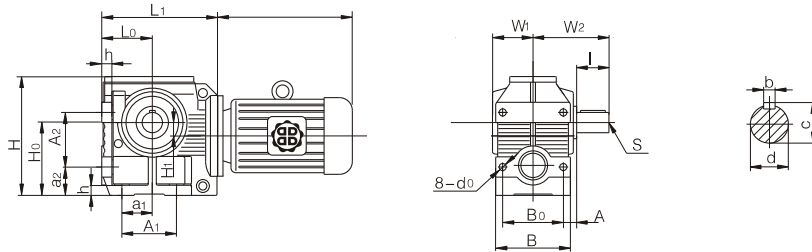

型号 Type	安装尺寸 Installion Size								轴伸尺寸 Stalk Size							外型尺寸 Features Size						
	H <sub>0</sub>	A	A <sub>1</sub>	A <sub>2</sub>	B <sub>0</sub>	a <sub>1</sub>	a <sub>2</sub>	L <sub>0</sub>	d <sub>0</sub>	d(k6)	l	b	c	S	L <sub>1</sub>	B	W <sub>1</sub>	W <sub>2</sub>	h	H	H <sub>1</sub>	
DS32	88	12	63	80	90	35	40	63	9	20	40	6	22.5	M6	143	110	55	97	10	151	0	
DS42	100	15	80	80	100	35	35	75	11	25	50	8	28	M8	171	120	55	115	15	166	11	
DS52	112	21	100	100	110	45	35	80	11	30	60	8	33	M10	187	136	70	136	16	187	24	
DS62	140	25	130	130	130	63	40	107	13.5	35	70	10	38	M10	242	160	79	160	20	236	24	
DS72	180	28	135	135	150	75	70	125	17.5	45	90	14	48.5	M16	287	185	100	193	25	295	33	
DS82	225	35	180	180	200	92	82	150	22	60	120	18	64	M20	340	250	120	255	30	362	40	
DS92	280	30	235	235	250	115	90	180	26	70	140	20	74.5	M20	420	300	140	295	36	448	53	

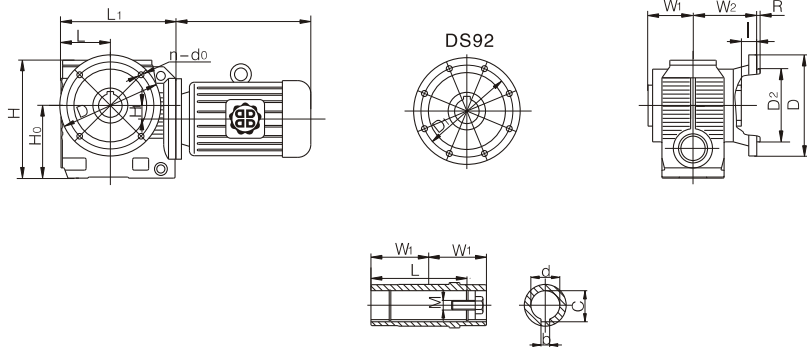

型号 Type	安装尺寸 Installion Size							轴伸尺寸 Stalk Size							外型尺寸 Features Size						
	H <sub>0</sub>	D <sub>1</sub>	n	d <sub>0</sub>	D <sub>2</sub> (h7)	L <sub>0</sub>	R	d(H7)	b	c	L	M	I	L <sub>1</sub>	D	W <sub>1</sub>	W <sub>2</sub>	H	H <sub>1</sub>		
DSAF32	88	100	4	7	80	63	3.5	20	6	22.8	104	M6	15	143	120	60	75	151	0		
DSAF42	100	130	4	9	110	75	3.5	25 30	8	28.3 33.3	105	M10	23.5	171	160	60	83.5	180	11		
DSAF52	112	165	4	11	130	80	3.5	30 35	8 10	33.3 38.3	132	M12	21.5	187	200	75	96.5	187	24		
DSAF62	140	165	4	11	130	105	4	40 45	12 14	43.3 48.8	144	M16	36	240	200	84	120	236	24		
DSAF72	180	215	4	13.5	180	122	4	50 60	14 18	53.8 64.4	183	M20	39.5	284	250	105	144.5	295	33		
DSAF82	225	300	4	17.5	250	147	5	60 70	18 20	64.4 74.9	220	M20	45	337	350	125	170	362	40		
DSAF92	280	400	8	17.5	350	176	5	70 90	20 25	74.9 95.4	260	M24	50	416	450	145	195	448	53		



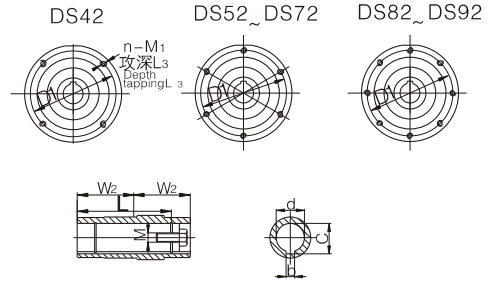
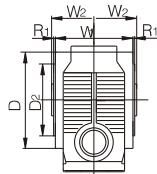
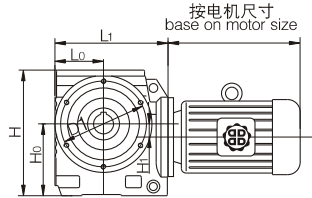

型号 Type	安装尺寸 Installation Size							轴伸尺寸 Stalk Size					外型尺寸 Features Size						
	H <sub>0</sub>	D <sub>1</sub>	L <sub>3</sub>	n	M <sub>1</sub>	D <sub>2</sub> (h7)	R <sub>1</sub>	d(H7)	b	c	L	M	L <sub>1</sub>	L <sub>0</sub>	D	W <sub>1</sub>	W <sub>2</sub>	H	H <sub>1</sub>
DSA42	100	115	12	4	M8	95	3	25	8	28.3	105	M10	171	75	135	110	60	180	11
DSA52	112	130	14	6	M8	110	3.5	30	8	33.3	132	M12	187	80	152	140	75	197	24
DSA62	140	165	15	6	M12	130	3.5	35	10	38.3	144	M16	240	105	195	158	84	246	24
DSA72	180	215	15	6	M12	180	4	40	12	43.3	183	M20	284	122	243	195	105	315	33
DSA82	225	265	25	8	M12	230	4	45	14	48.8	220	M20	337	147	292	240	125	382	40
DSA92	280	350	25	8	M16	300	5	50	18	53.8	260	M24	434	194	384	280	145	488	53

DS

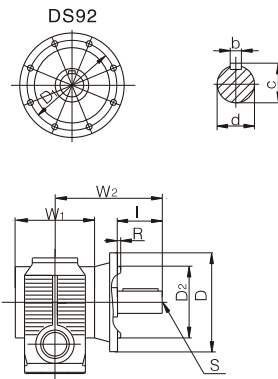
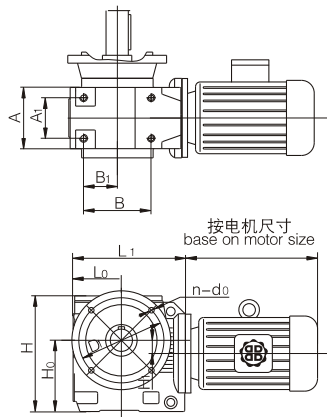

型号 Type	安装尺寸 Installation Size							轴伸尺寸 Stalk Size					外型尺寸 Features Size									
	H <sub>0</sub>	D <sub>1</sub>	n	d <sub>0</sub>	D <sub>2</sub> (h7)	R	A <sub>1</sub>	B <sub>1</sub>	d(k6)	l	b	c	S	L <sub>1</sub>	L <sub>0</sub>	D	W <sub>1</sub>	W <sub>2</sub>	H	H <sub>1</sub>	A	B
DSF32	88	100	4	7	80	3.5	-	-	20	40	6	22.5	M6	143	63	120	110	115	151	0	88	-
DSF42	100	130	4	9	110	3.5	60	35	25	50	8	28	M8	171	75	160	110	133.5	180	11	88	87
DSF52	112	165	4	11	130	3.5	60	58.5	30	60	8	33	M10	187	80	200	140	156.5	187	24	96	117
DSF62	140	165	4	11	130	4	88	71.5	35	70	10	38	M10	240	105	200	158	190	236	24	125	152
DSF72	180	215	4	13.5	180	4	102	85	45	90	14	48.5	M16	284	122	250	200	234	295	33	154	170
DSF82	225	300	4	17.5	250	5	118	115	60	120	18	64	M20	337	147	350	240	290	362	40	194	225
DSF92	280	400	8	17.5	350	5	160	135	70	140	20	74.5	M20	416	176	450	280	335	448	53	234	248



DS32~DS42

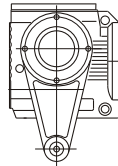

DS52~DS92

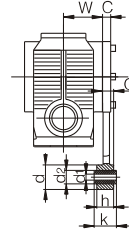
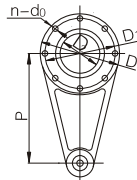

型号 Type	安装尺寸 Installation Size						外型尺寸 Features Size								
	D <sub>1</sub>	D <sub>2</sub> (H7)	n	d <sub>0</sub>	P	d <sub>1</sub> ±0.1	D	K	h	d	W	C	O	d <sub>2</sub> (H7)	
DSA32/T...度	85	60	4	7	110	10.4	98	36	31	45	55	10	23.5	25	
DSA42/T...度	115	65	4	9	130	10.4	130	36	31	45	55	15	20.5	25	
DSA52/T...度	102	80	8	9	160	10.4	120	36	31	45	70	15	18.5	25	
DSA62/T...度	130	85	8	13.5	200	10.4	155	36	31	45	79	18	19.5	25	
DSA72/T...度	155	110	8	13.5	250	16.4	180	60	54	58	100	18	32.5	36	
DSA82/T...度	180	130	8	17.5	310	16.4	215	60	54	58	120	24	25.5	36	
DSA92/T...度	220	150	8	17.5	380	25	260	80	72	82	140	26	33	52	

注：扭力臂安装请注明安装角度。Note: please note the installation angle for the torsional arm

DSAS型

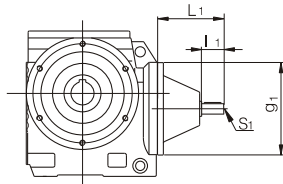

DSS型

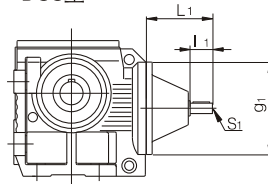

DSFS型

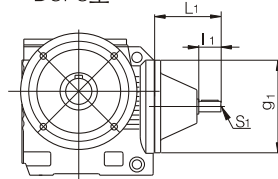

DSAFS型

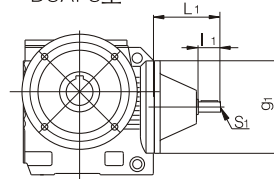

型号 Type	d <sub>1</sub> (k6)	L <sub>1</sub>	l <sub>1</sub>	S <sub>1</sub>	C <sub>1</sub>	b <sub>1</sub>	g <sub>1</sub>
DS...S32	16	115	40	M4	18	5	120
DS...S42	16	115	40	M4	18	5	120
DS...S52	19	120	40	M5	21.5	6	160
DS...S62	19	120	40	M5	21.5	6	160
DS...S72	24	140	50	M6	27	8	200
DS...S82	28	180	60	M8	31	8	250
DS...S92	38	220	80	M12	41	10	300

注：其它尺寸请参照DS系列。

Notes: refer other dimensions to DS series.

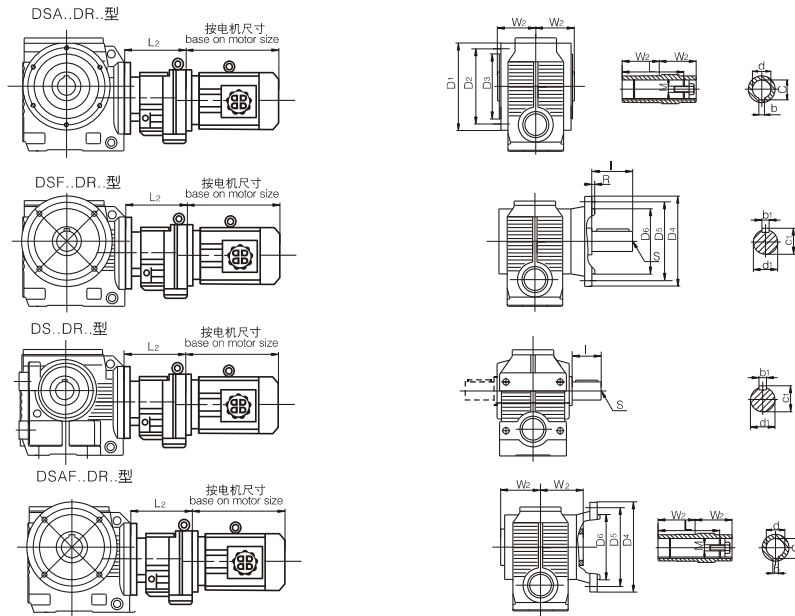

DS

型号 Type	安装尺寸 Installation Size						轴伸尺寸 Stalk Size						外型尺寸 Features Size						
	D1	D2	D3(h7)	D4	D5	D6(h7)	d(H7)	d1(h7)	c	c1	b	b1	W2	L	M	I	R	S	L2
DS...32DR33	-	-	-	120	100	80	20	20	22.8	22.5	6	6	60	104	M6	40	3.5	M6	161
DS...42DR33	135	115	95	160	130	110	25	25	28.3	28	8	8	60	105	M10	50	3.5	M8	161
DS...52DR33	152	130	110	200	165	130	30	30	33.3	33	8	8	75	132	M12	60	3.5	M10	161
DS...62DR33	195	165	130	200	165	130	40	35	43.3	38	12	10	84	144	M16	70	4	M10	161
DS...72DR33	243	215	180	250	215	180	50	45	53.8	48.5	14	14	105	183	M20	90	4	M16	161
DS...82DR43	292	265	230	350	300	250	60	60	64.4	64	18	18	125	220	M20	120	5	M20	175
DS...92DR63	384	350	300	450	400	350	70	70	74.9	74.5	20	20	145	260	M24	140	5	M20	210

注:其它尺寸请参见DS、DSA、DSF、DSAF型。Notes:other dimensions to DS、DSA、DSF、DSAF series

**DS系列油量表(L):**

Type	W1、W5、FW1、	L5、L3、FL2、L1、L3	W7、FW4、W4、	L、L2、FL、L4	W2、LW2、W6、F2、
<b>DS32</b>	0.25	0.4	0.5	0.6	0.4
<b>DS42</b>	0.4	0.9	0.9	1.2	1.0
<b>DS52</b>	0.5	1.2	1	1.6	1.4
<b>DS62</b>	1	2.2	3.1	3.2	2.7
<b>DS72</b>	1.9	4.2	5.8	6.5	4.9
<b>DS82</b>	3.8	8.1	10.4	12	9.1
<b>DS92</b>	7.4	15	18.8	23.6	18
<b>DS102</b>	10.4	38	31.5	38	21.2
<b>DS122</b>	18.3	67	53	67	35.7



DS102 .DS122 安裝方位和尺寸圖表

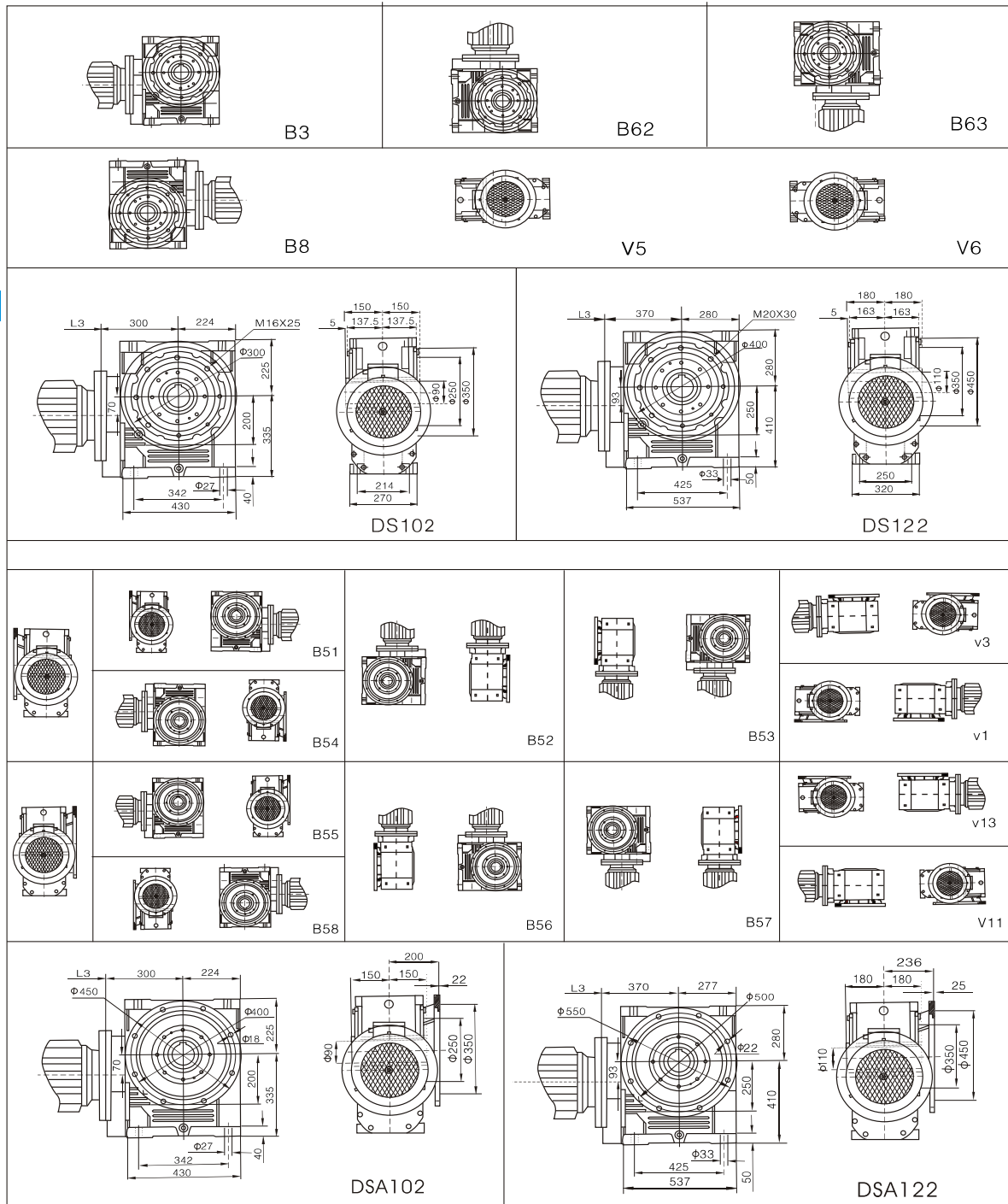

DS